

A CISTERNA SERÁ INSTALADA NO PAVIMENTO BALDRAME ABAIXO DOS SANITÁRIOS

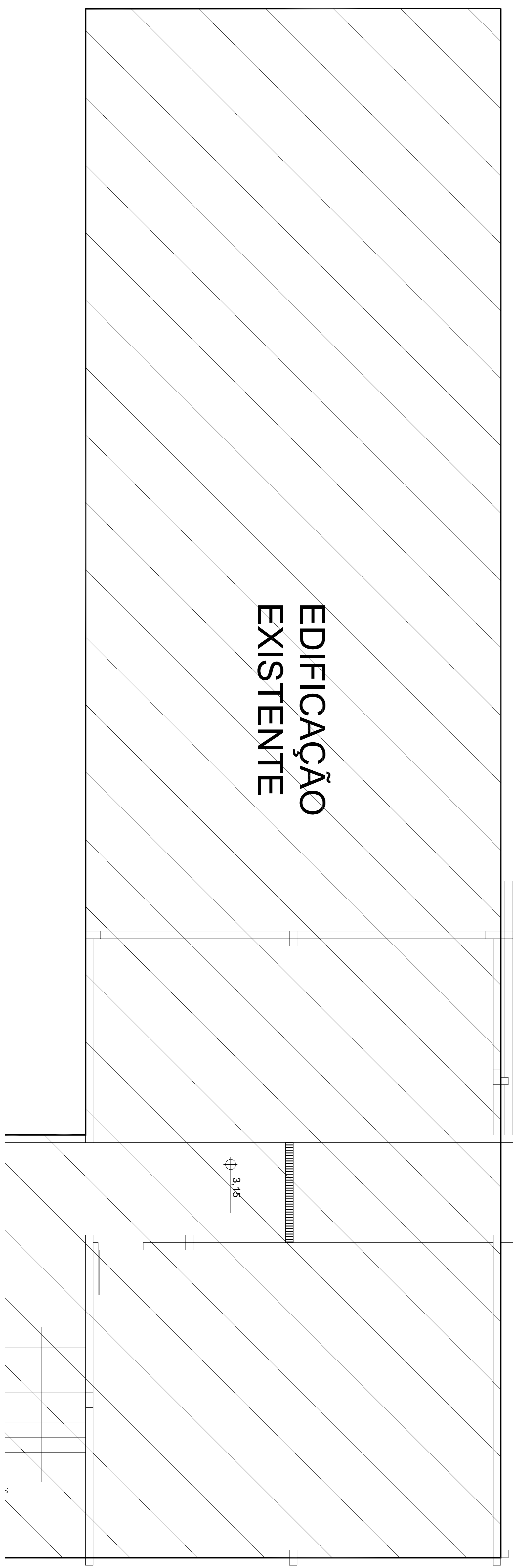

Carimbos:

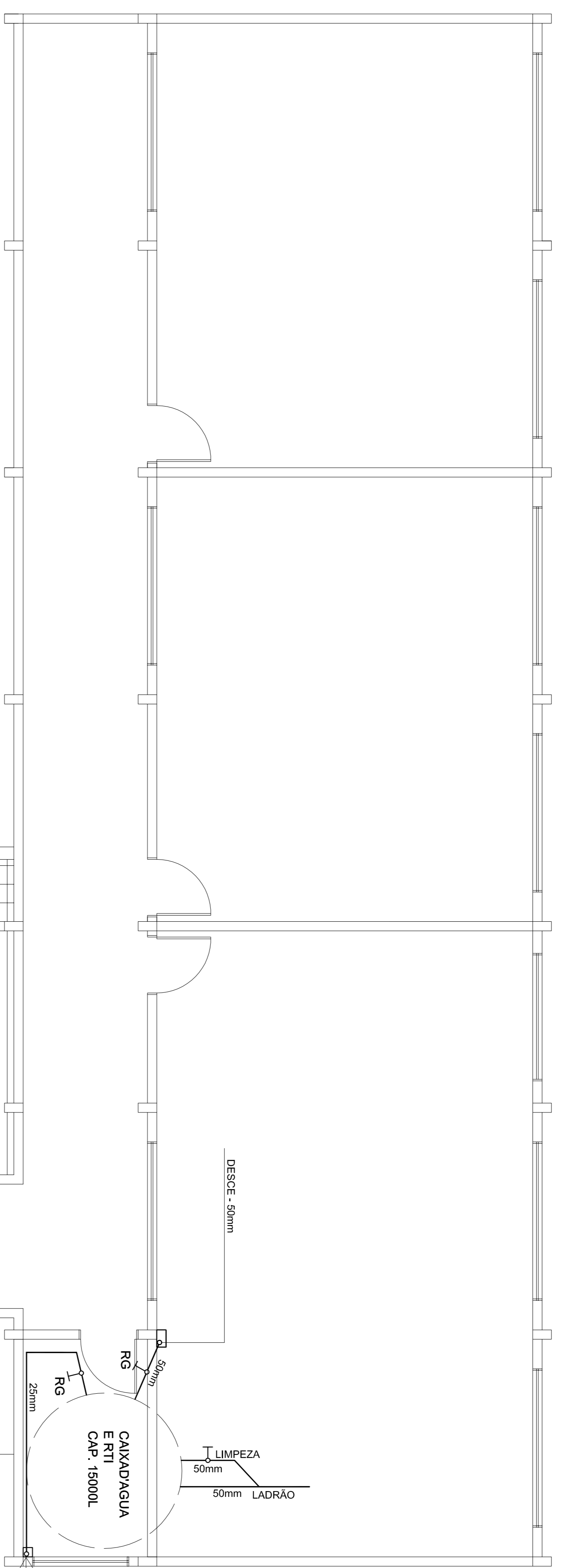
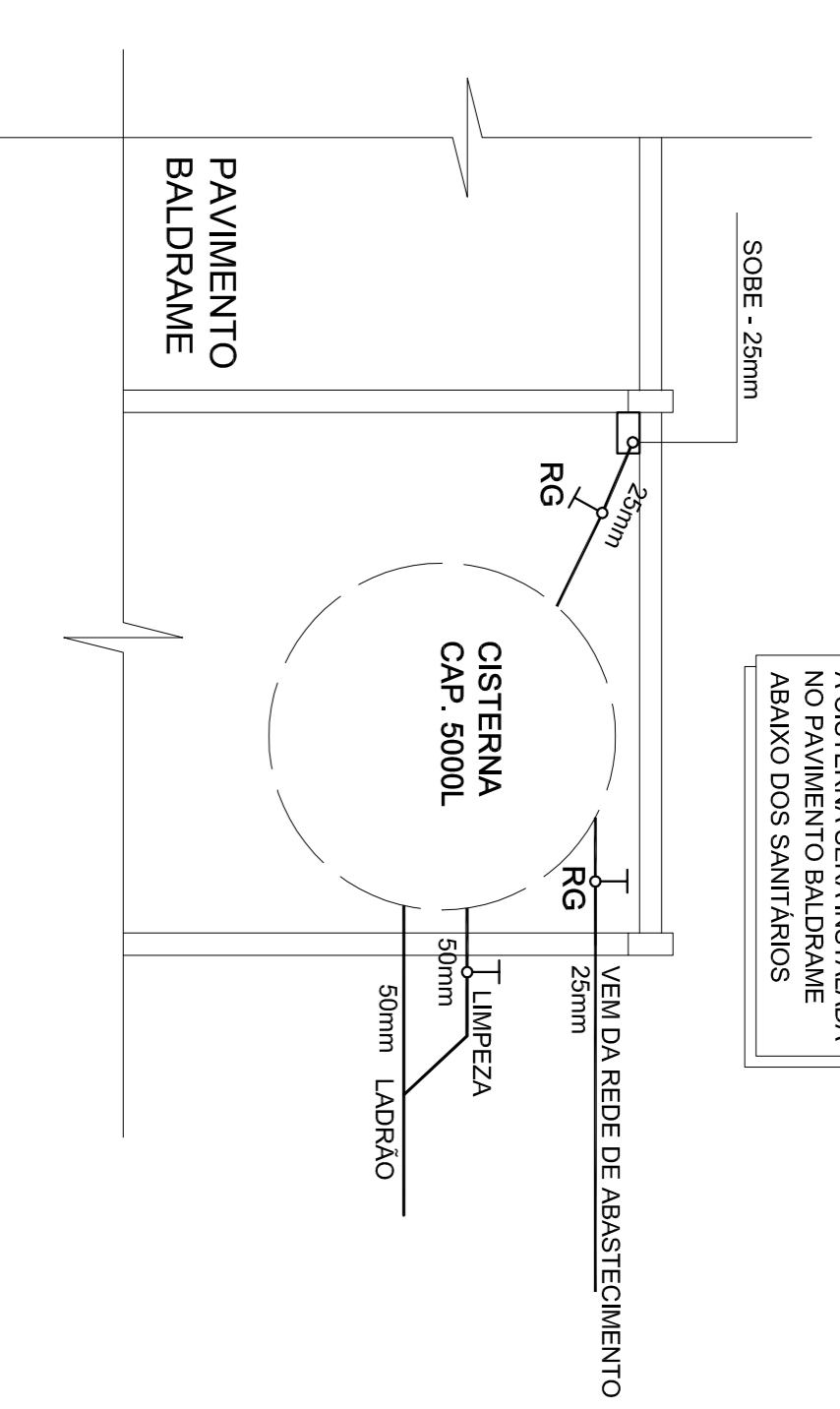

Obra: Ampliação Escola São Roque

Endereço: Rod SC 110 São Roque - Timbó - SC

Projeto: Hidráulico - superior

Resp. Técnico Projeto:

Data:	Escala:	Área:	Prancha:
Nov./2014	1 / 50	497,62m <sup>2</sup>	Hid.02